



PC SERIES UNITS SPARE PARTS LISTING

General Notes:

Always replace parts using LRC Coil parts for maximum life from the unit.

**DISCONNECT POWER BEFORE SERVICING UNIT OR INJURY
MAY RESULT**

Interpreting Serial Numbers

LRC Coil serial numbers are arranged with a unique serial number and date code.

#####-YYMM

- unique serial number
YYMM – Year Month of manufacture

Capacity/Part Nomenclature – PCA/E/H units used 2 different numbering system from the 1980's onward. Early units used the PC(A,E,H) CAP (capacity x 1000) “-” # Fans, FPI or the opposite - PC(A,E,H) # Fans, FPI CAP “-” (capacity x 1000)

PCA258-24 – 25,800 btuh @ +25 SST, 2 fans, 4 fins per inch
PCA24-258 - 2 fans, 4 fins per inch, 25,800 btuh @ +25 SST

Note: PCA – units rated at +25 SST, PCE/PCH units rated at -10SST

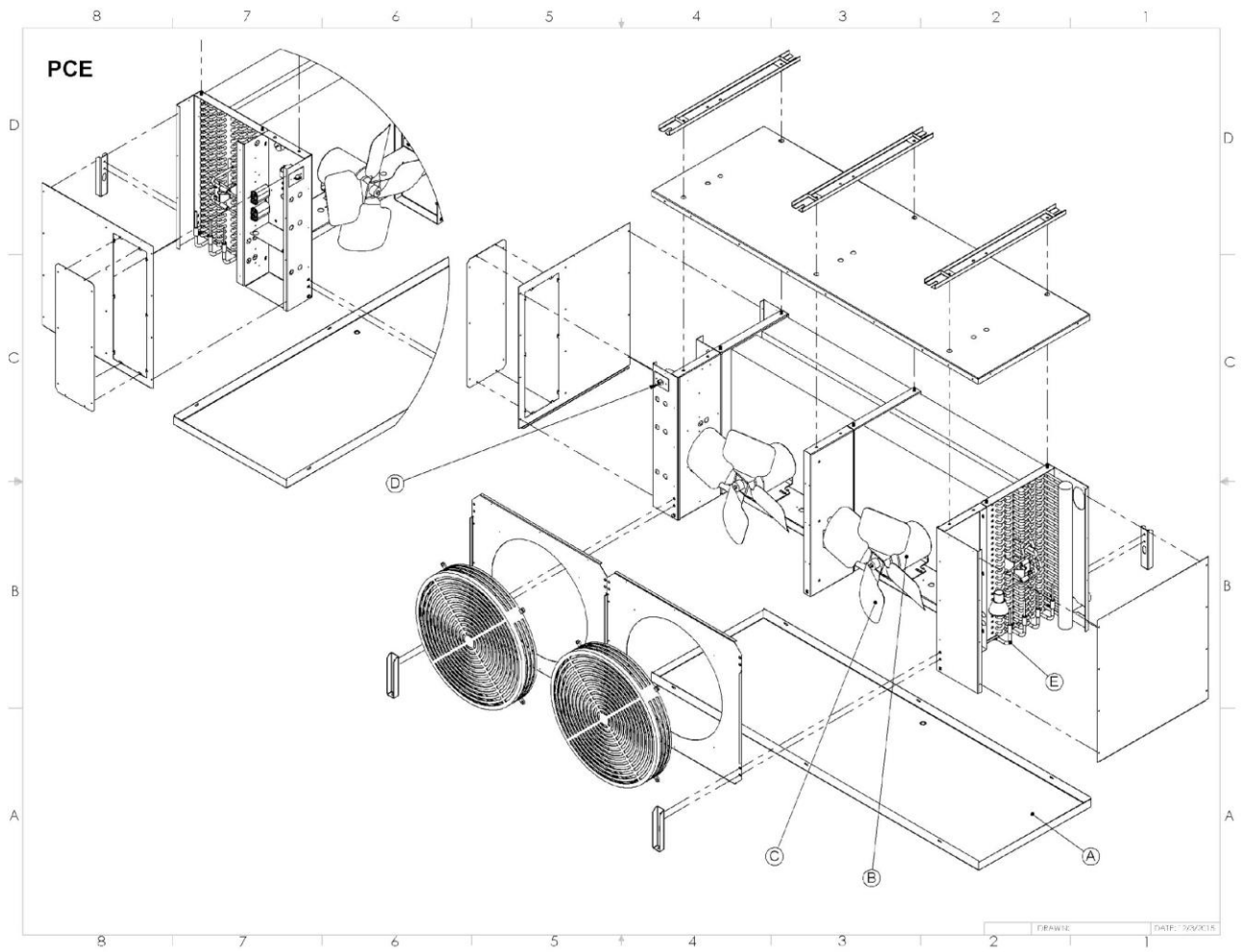

Model	Part Description	PN	Comment
A	DrainPan		
	1 Fan	10425-1	PC & PCE-XXX-1X or 1X-XXX
	2 Fan	10425-2	PC & PCE-XXX-2X or 2X-XXX
	3 Fan	10425-3	PC & PCE-XXX-3X or 3X-XXX
	4 Fan	10425-4	PC & PCE-XXX-4X or 4X-XXX
			Post 1990 models only
B	Motor		
	208-230/460 1Phase	2216	3/4hp – 208-230/460 1 phase
	208-230/460 3 Phase	2930	3/4hp – 208-230/460 3 phase
C	Fan Blade	1810	20”
D	Defrost Control	Obsolete	Ranco F25 series controller-available at wholesalers
	Defrost Termination	2166	Not Shown (2 wire)
E	Defrost Heaters –		
	1 Fan	1816	875W, 16”, 230VAC (4 or 6 per unit depending on configuration - verify)
	2 Fan	1817	1600W, 29.5”, 230VAC(4 or 6 per unit depending on configuration - verify)
	3 Fan	1818	2330W, 43”, 230VAC(4 or 6 per unit depending on configuration - verify)
	4 Fan	1819	3000W, 56.5”, 230VAC(4 or 6 per unit depending on configuration - verify)

Drainpans not available on units prior to 1990.